

# LOG WOOD PACKING TABLE ASSEMBLY MANUAL

## Step 1.

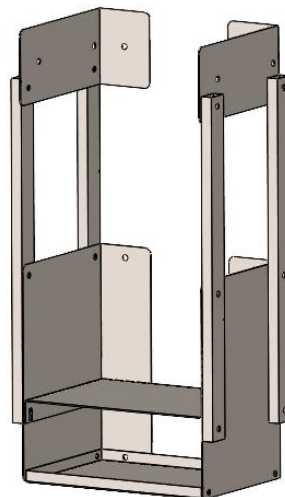
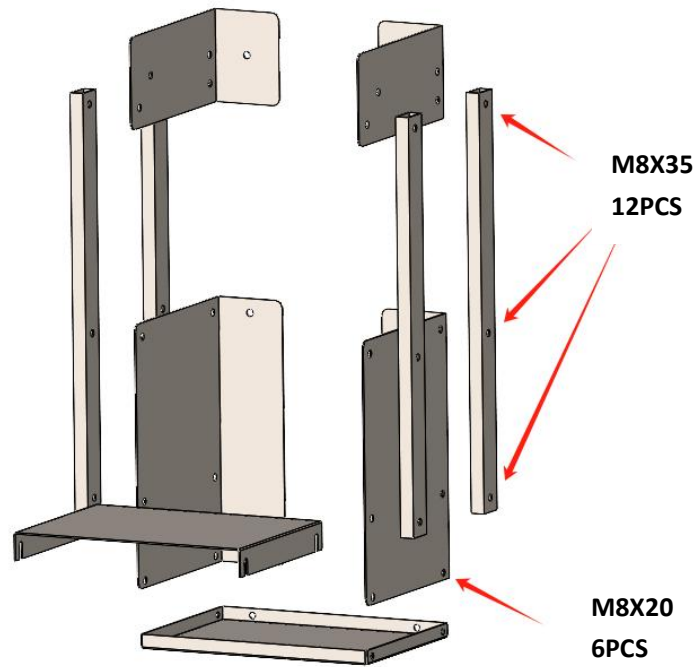

**NOTE:** all the bolts install from inside; two brackets assemble the same way.

# LOG WOOD PACKING TABLE ASSEMBLY MANUAL

## Step 2.

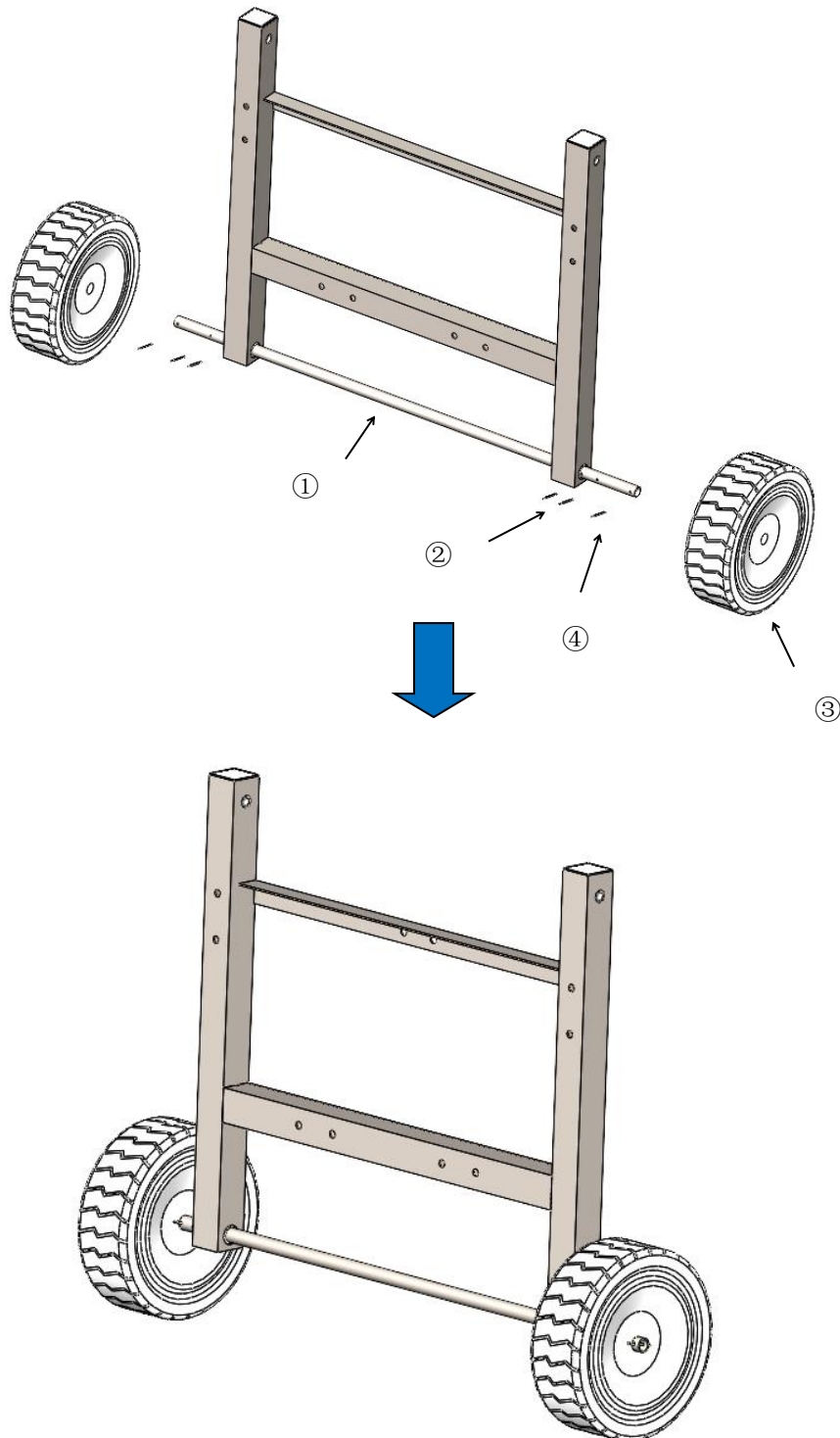

**NOTE:** ① Assemble axle tube, ② assemble 4 pcs split pin inside, ③ assemble 2 wheel, ④ assemble 2 split pin.

# LOG WOOD PACKING TABLE ASSEMBLY MANUAL

## Step 3.

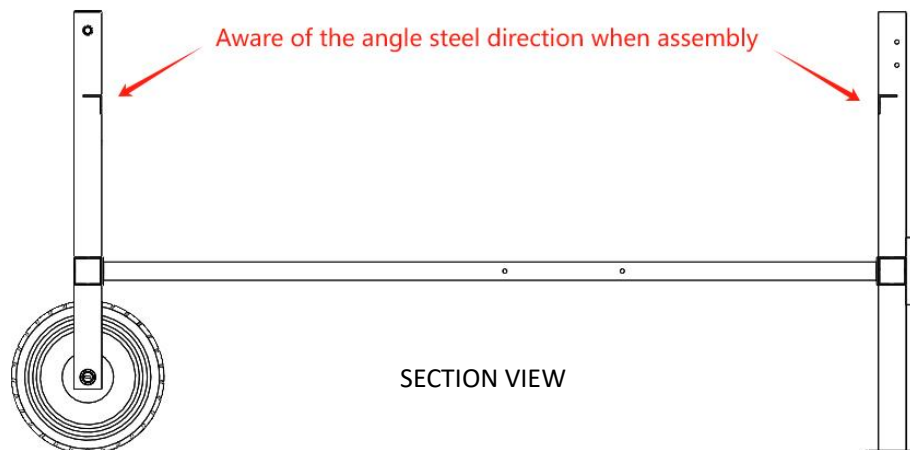
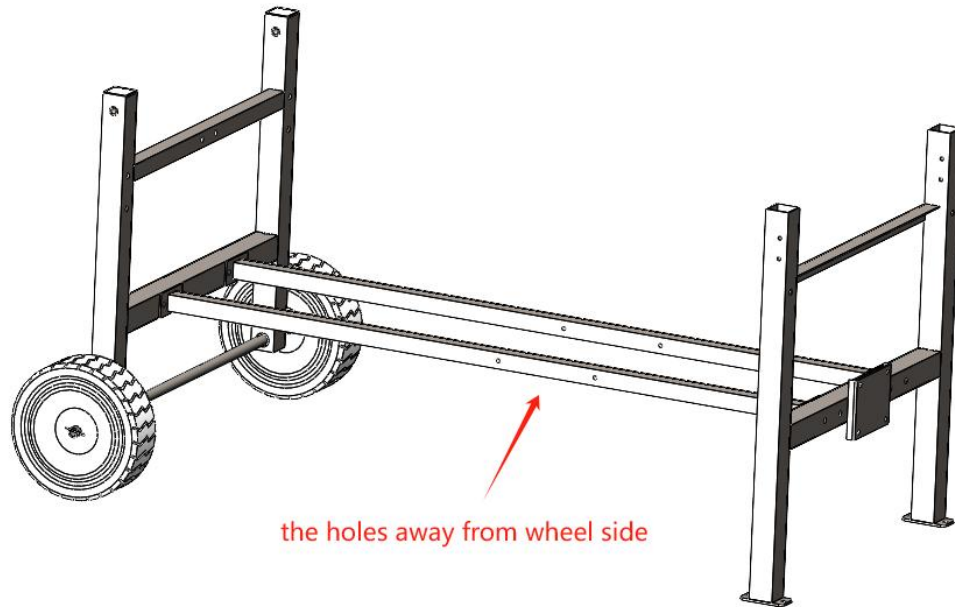

**NOTE:** use 8 pcs M12X80 bolts and nuts

# LOG WOOD PACKING TABLE ASSEMBLY MANUAL

## Step 4.

this corner don't assemble bolts at this step

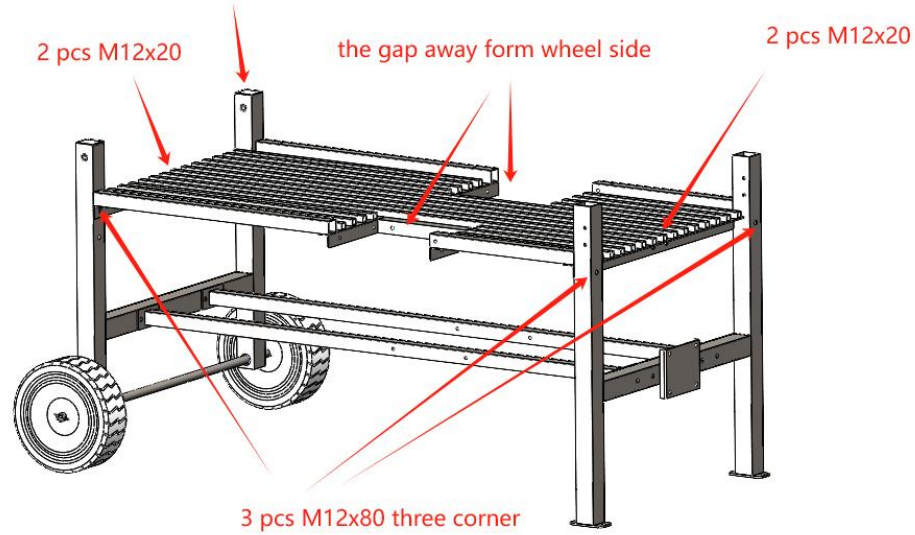

## Step 5.

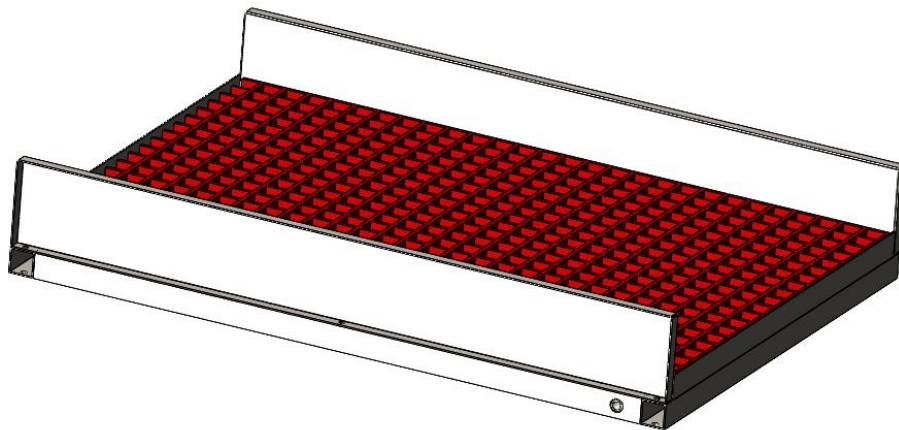

**NOTE:** Use 6 pcs M8x55 bolts and nuts, and 6 pcs silicone gasket as spacer.

# LOG WOOD PACKING TABLE ASSEMBLY MANUAL

## Step 6.

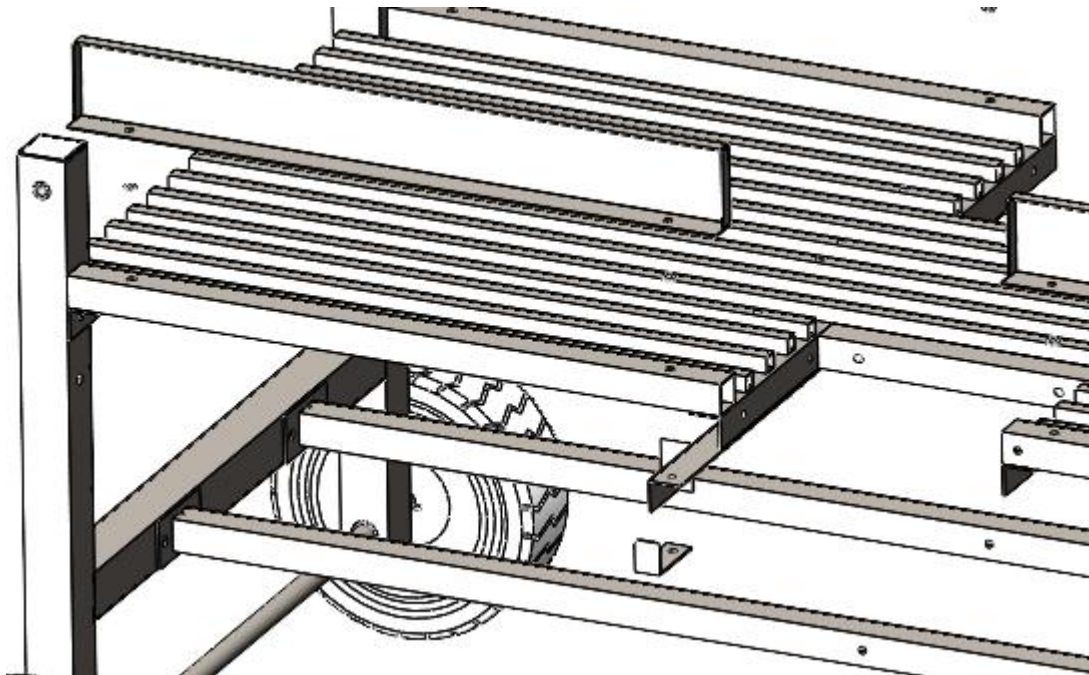
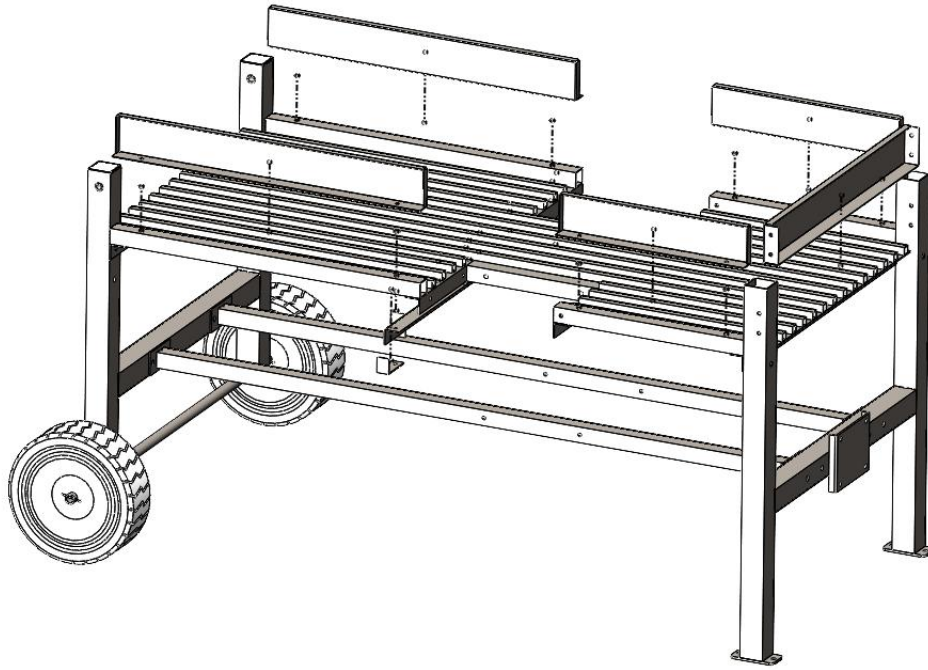

Detail view 1

# LOG WOOD PACKING TABLE ASSEMBLY MANUAL

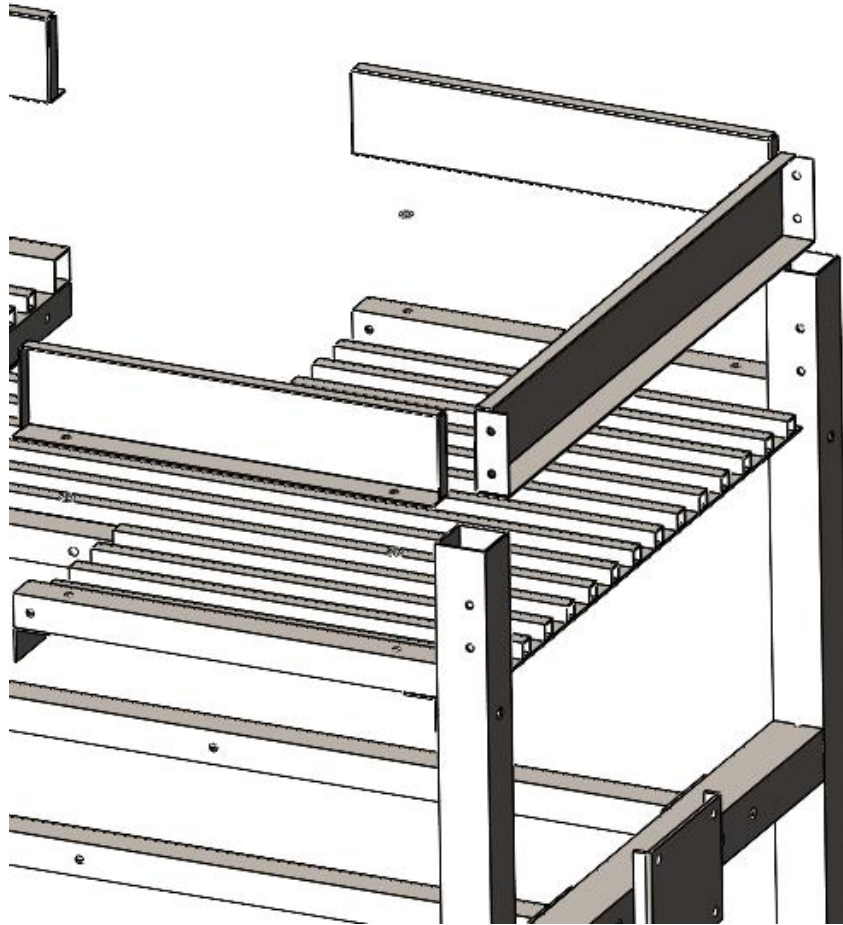

Detail view 2

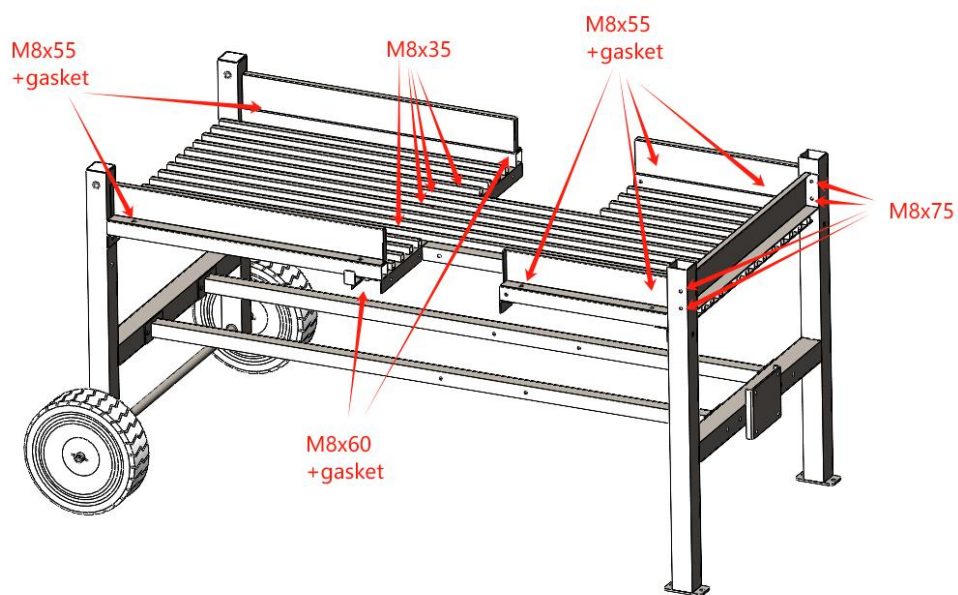

# LOG WOOD PACKING TABLE ASSEMBLY MANUAL

## Step 7.

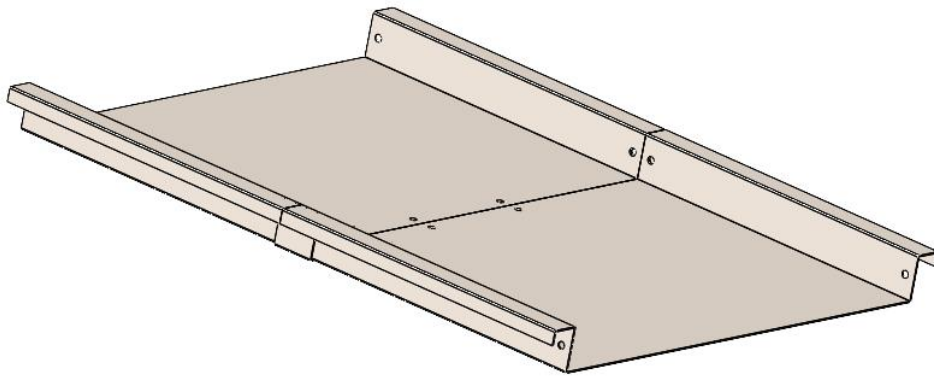
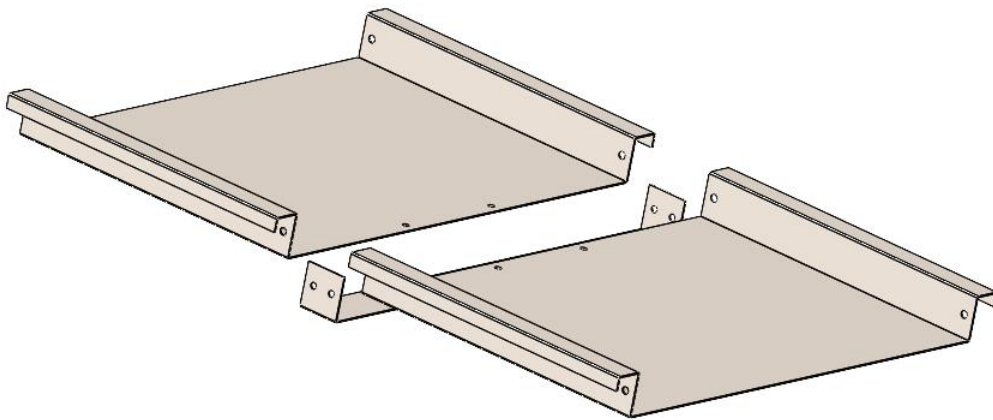

**NOTE:** Use 8 pcs M8x20 bolts and nuts

# LOG WOOD PACKING TABLE ASSEMBLY MANUAL

## Step 8.

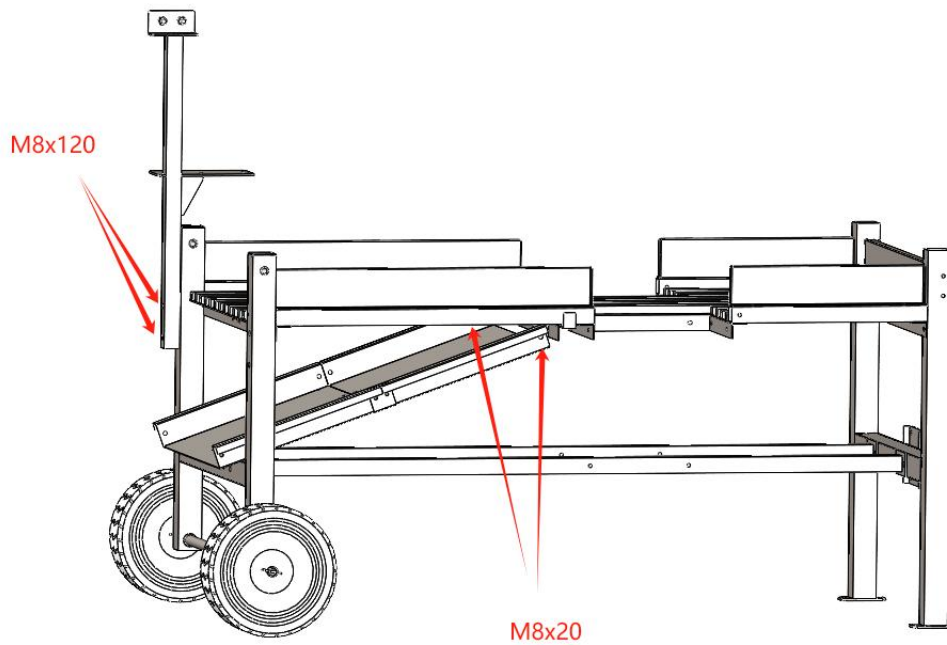
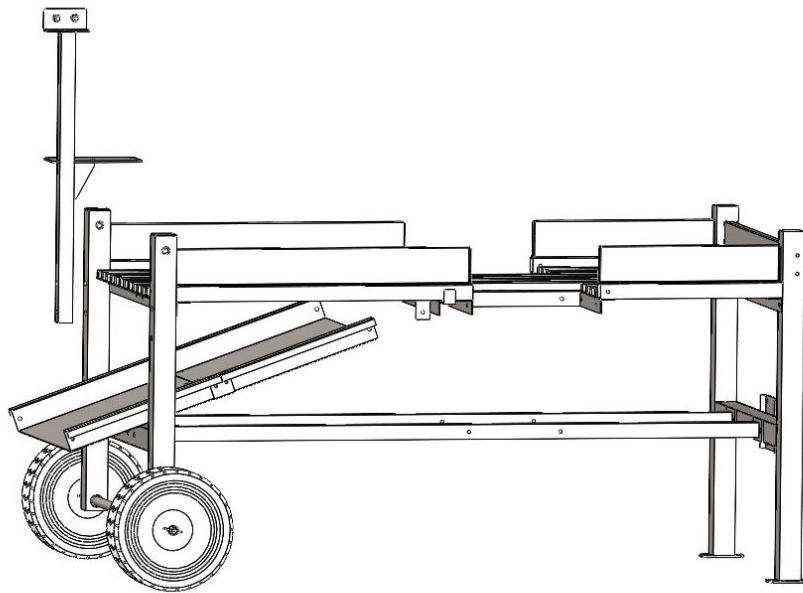



# LOG WOOD PACKING TABLE ASSEMBLY MANUAL

## Step 9.

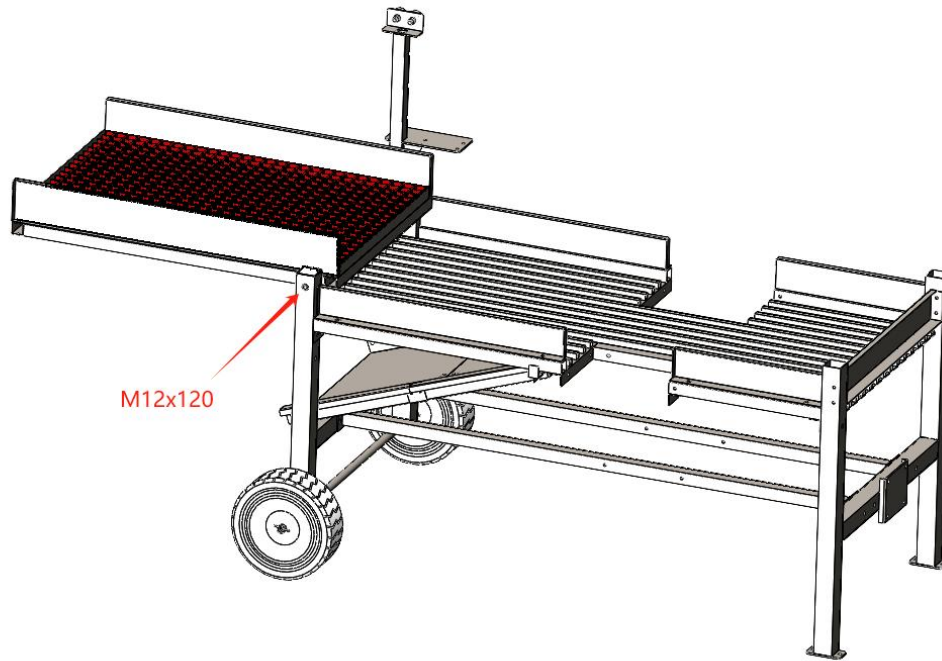

## Step 10.

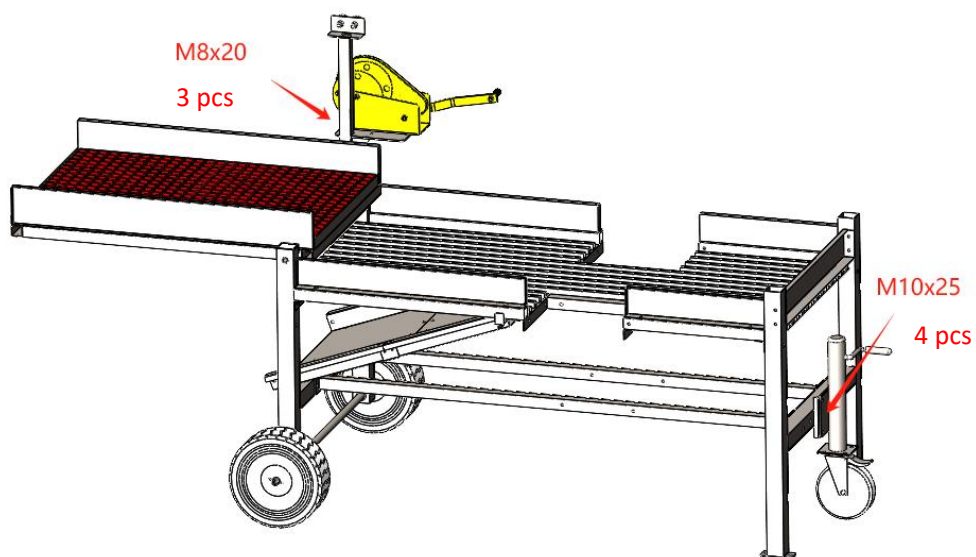

# LOG WOOD PACKING TABLE ASSEMBLY MANUAL

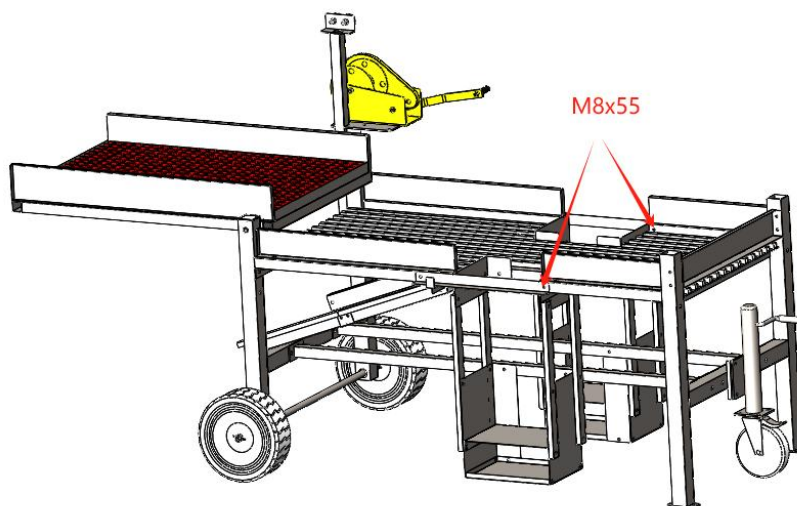
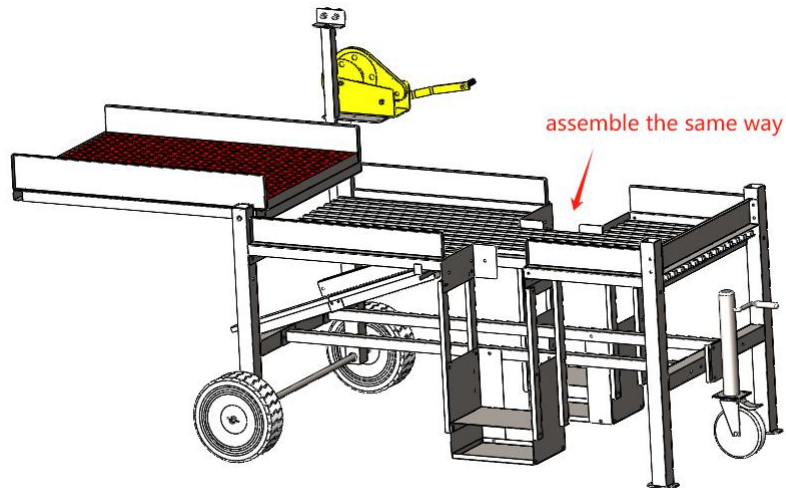
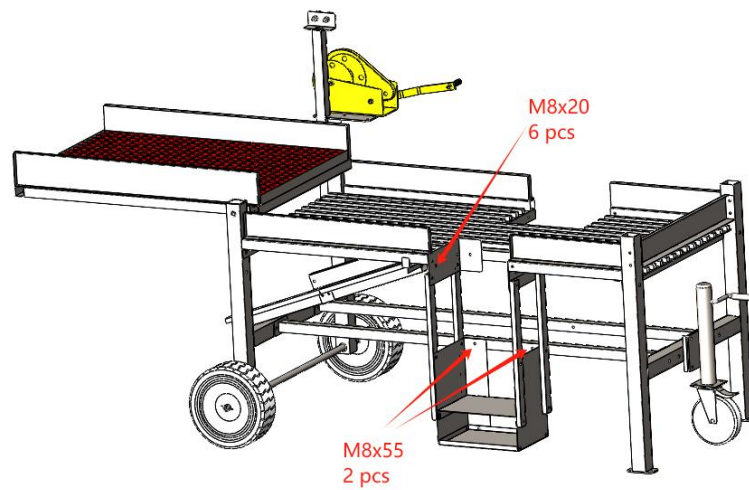

# LOG WOOD PACKING TABLE ASSEMBLY MANUAL



**Finish photo**